



BLUECHIP

Timber Cladding



ULTRAWOOD

System Brochure



www.bluechipgroup.net.au



ULTRAWOOD

Non-combustible Timber Cladding

Description

ULTRAWOOD non-combustible timber cladding is an innovative new generation cladding product made from highly durable marine-grade aluminium and factory prefinished using the latest matt-effect coating technology. Available in a wide range of realistic timber colours, ULTRAWOOD is deemed-to-satisfy non-combustible a per NCC 2022, Clause C2D10 requirements and has been fully tested in Australia by CSIRO to AS 1530.1 and AS 1530.3. Eco-friendly, low maintenance and incredibly strong, ULTRAWOOD is ideal for type A and B construction projects such as high-rise apartments which require non-combustible cladding.

Product Benefits



AS 1530.1 NON-COMBUSTIBLE

ULTRAWOOD is a non-combustible cladding product in accordance with the relevant requirements of the NCC 2022, Clause C2D10 and has been tested by NATA accredited CSIRO to AS 1530.1 and AS 1530.3.



MARINE GRADE DURABILITY

Made from 100% marine-grade aluminium, ULTRAWOOD offers outstanding long-term durability and strength with guaranteed resistance against; twisting, warping, rotting, splitting, cracking or insect attack.



INTELLIGENT PROFILE

The ULTRAWOOD profile has been intelligently designed to provide excellent usability such as multi-angle mating and it has double swarf-free contact points for superior consistency and weather-proofing.



EASY INSTALLATION

Supplied in custom lengths, ULTRAWOOD has 155mm cover per board making it fast and easy to install to a simple sub-frame at 600mm centres using secret-fix screws and a colour-matched trim system.



VERY LIGHT-WEIGHT

Compared to many other timber cladding products, ULTRAWOOD is a very light-weight system weighing only 8.75kg per square metre offering potential structural advantages and cost savings.



SUSTAINABLE CHOICE

ULTRAWOOD is one of the most sustainable construction materials because it can be infinitely recycled without losing any of its outstanding physical properties. 85% of aluminium ever-made is still in use today.



NATURAL AESTHETICS

The attractive finish on the ULTRAWOOD boards is possible because the latest matt-effect coating technology provides incredible natural variation along with outstanding long-term protection for the aluminium.



COLOUR-MATCHED TRIMS





The ULTRAWOOD system is completed using the CLADTRIM click-together trim system covering all common construction details and finished in exactly the same matt-effect coating for a perfect match.

INSTALL & TECHNICAL

For installation and technical information, scan the QR code and view 'Downloads' tab.

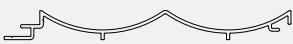

Profiles

	Code: UW*G ULTRAWOOD 155 x 18 Groove Profile
	Code: UW*C ULTRAWOOD 155 x 25 Cabin Profile
	Code: UW*F ULTRAWOOD 155 x 18 Flute Profile
	Code: UW*D ULTRAWOOD 155 x 18 Duoflute Profile
	Code: UWC15024 ULTRAWOOD 150 x 24 Castellated Profile

Availability

CODE	DESCRIPTION	LEAD TIME	MOQ
UW*G15518	ULTRAWOOD 155 x 18mm Groove (Colour), 6.5m Length	4-5 Weeks	1 Length
UW*C15525	ULTRAWOOD 155 x 25mm Cabin (Colour), 6.5m Length	8-10 Weeks	50 Lengths
UW*F15518	ULTRAWOOD 155 x 18mm Flute (Colour), 6.5m Length	8-10 Weeks	50 Lengths
UW*D15518	ULTRAWOOD 155 x 18mm Duoflute (Colour), 6.5m Length	8-10 Weeks	50 Lengths
UWC15024	ULTRAWOOD 150 x 24mm Castellated (Colour), 5.0m Length	8-10 Weeks	50 Lengths

Colour-Matched Trims

CODE	DESCRIPTION	LEAD TIME	MOQ
CT*SS	CLADTRIM J-shape Starter Strip (Colour), 5.5m Length	2-3 Weeks	1 Length
CT*ZPET	CLADTRIM Z-shape Joint Profile (Colour), 5.5m Length	2-3 Weeks	1 Length
CT*CP	CLADTRIM 40mm 2-piece Corner (Colour), 5.5m Length	2-3 Weeks	1 Length
CT*CS	CLADTRIM 40mm 2-piece Cover Strip (Colour), 5.5m Length	2-3 Weeks	1 Length
CT*ZPET	CLADTRIM 40mm 2-piece Edge Trim (Colour), 5.5m Length	2-3 Weeks	1 Length
CT*XXXX	CLADTRIM 50/40/20mm Angle (Colour), 6.5m Length	2-3 Weeks	1 Length

*The asterisk in the code denotes the specified type of finish to be applied to the aluminium extrusion as follows:
 U = Ultrawood Timber Colours, A = Anodised Colours and P = Powdercoat Colours.

System Components

				
Facade System	AS 1530.1 Insulation	Class 4 Membrane	Steel Top-hats	Joint Sealant

ULTRAWOOD

The Complete Package

1

Innovative support system:

Brackets and rails designed for high performance, design flexibility, and efficient installation

2

Certified fasteners and anchors:

All fixing components are manufactured from high quality corrosion resistant materials for long-term durability, strength, and ultimately, peace of mind

3

Full project support:

Expect BLUECHIP-grade customer service across your entire project, from tender to installation

4

Reliable technical advice:

Our technical teams undertake all the calculations and drawings you need quickly and accurately, and provide you with technical advice you can trust

5

Fast turnaround:

A timely response on indicative costs, schematic drawings and quotes, and prompt on-site delivery - we have the set-up you need to keep your project moving

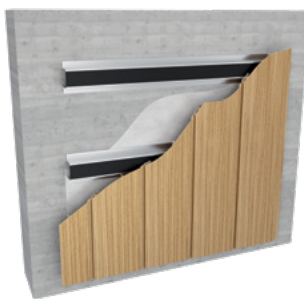



Highly versatile: The bracket and rail system can be configured for any rainscreen façade project – including sloping façades and curved structures. It is suitable for any substrate, cladding material or insulation thickness. As well as accommodating both vertical and horizontal installation configurations, the system can also be used in soffit applications

Third-party accredited: The BICEP® facade support system is manufactured to all current regulations and standards including EN1090, ISO9001 and ISO14001

Speed of installation: The system is configured to ensure quick and easy installation while maintaining the accuracy required for structural security

Cost effective: Thanks to the strength of the unique patented bracket design, potentially fewer brackets are needed per square metre – ensuring maximum quality and performance for minimum cost

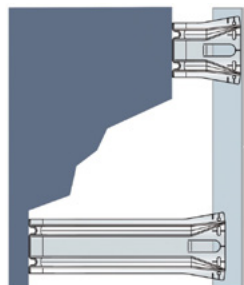
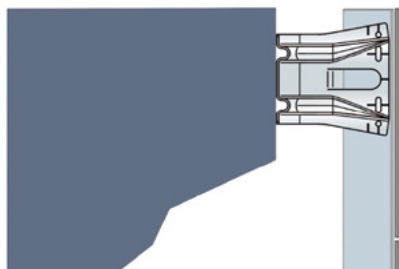
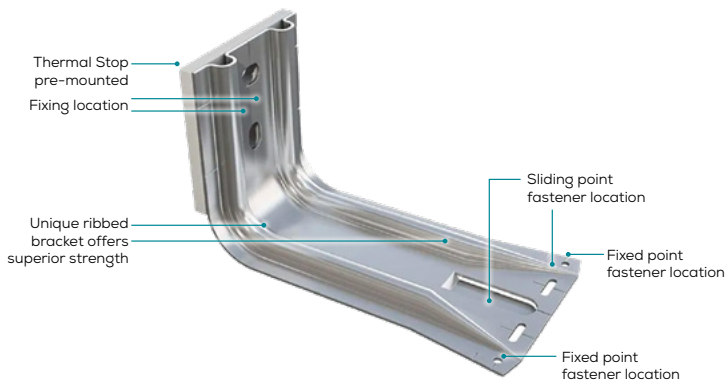

ULTRAWOOD

Insulated Horizontal Installation

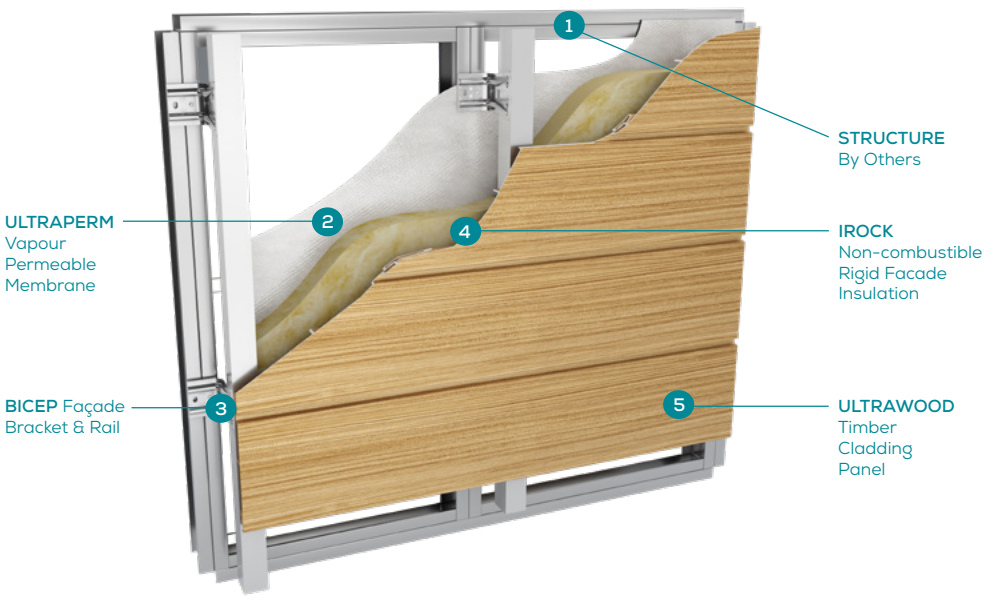

Facade System Compliance

DESCRIPTION	NCC SECTION	AS/NZS TEST	RESULT
FIRE PERFORMANCE	C2D10(6)(e)	AS 1530.1 AS 1530.3	Deemed Non-combustible
CONDENSATION PERFORMANCE	F8D3	AS 4200.1 ASTM E96-2016	PASS PASS - Class 4
WEATHER PROOFING PERFORMANCE	F3P / F3VI H2P2 / H2VI	AS 4284	PASS
THERMAL PERFORMANCE	J4D3 J3D6	AS 4859.1 / ASTM C518	0.036W/mK 0.06W/mK
ACOUSTIC		ISO 354-2006	1.0 NRC



Specification

SYSTEM DESCRIPTION	ULTRAWOOD Cassette Fixed to BICEP Bracket System with external IROCK Non-combustible Facade Insulation & Weather Barrier							
FACADE MATERIAL	ULTRAWOOD Non-Combustible Timber Cladding							
COLOUR	Refer External Finishes Schedule							
FIXING METHOD	Secret Mechanical Screw Fix – Horizontal Layout							
SUB-FRAME SYSTEM	BICEP Bracket System For Insulated Facades							
EXTERNAL INSULATION	IROCK Non-Combustible Facade Insulation							
WEATHER BARRIER	ULTRAPERM Class 4 Vapour Permeable Membrane							
INSTALLATION R-VALUE	30mm	40mm	50mm	60mm	80mm	100mm	120mm	140mm
	0.83	1.11	1.39	1.67	2.22	2.78	3.33	3.89

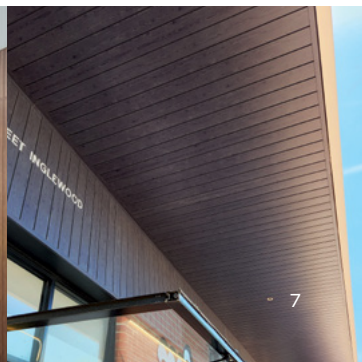
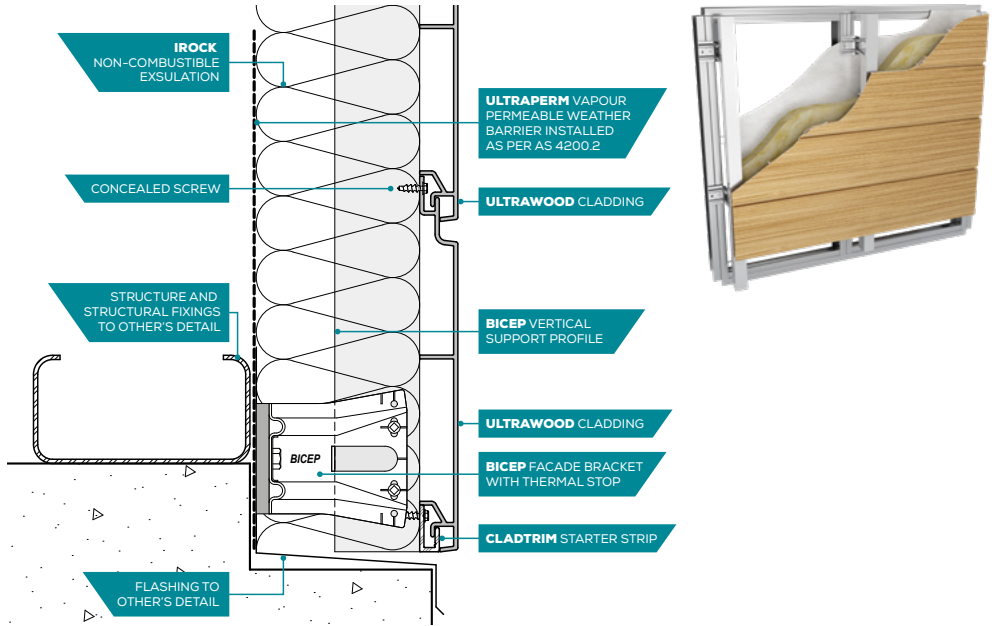

ULTRAWOOD

Standard Horizontal Installation

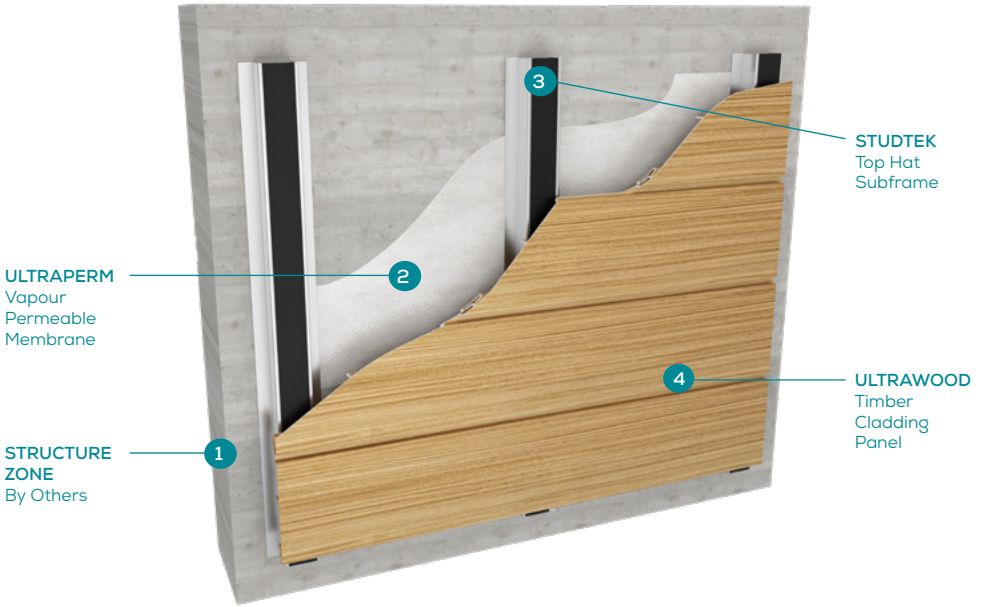

Facade System Compliance

DESCRIPTION	NCC SECTION	AS/NZS TEST	RESULT
FIRE PERFORMANCE	C2D10(6)(e)	AS 1530.1 AS 1530.3	Deemed Non-combustible
CONDENSATION PERFORMANCE	F8D3	AS 4200.1 ASTM E96-2016	PASS PASS - Class 4
WEATHER PROOFING PERFORMANCE	F3P1 / F3V1 H2P2 / H2V1	AS 4284	PASS



Specification



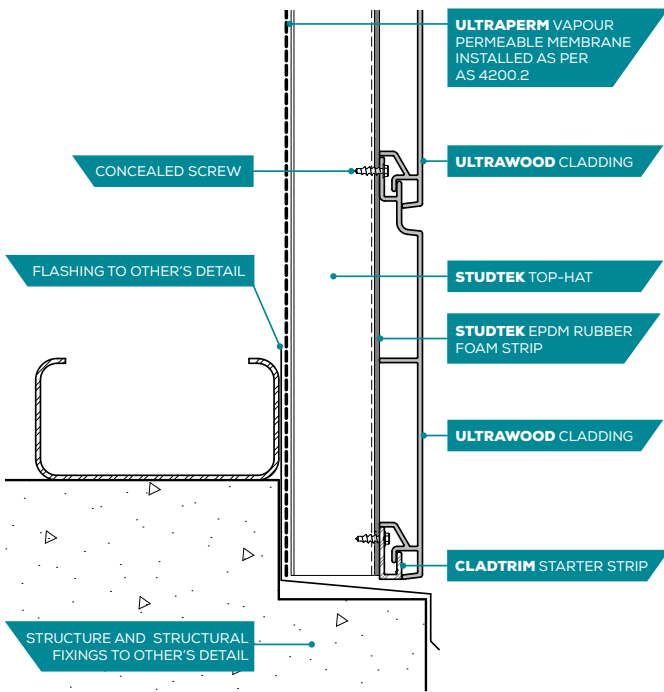





















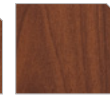



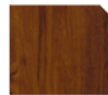
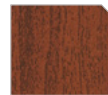



SYSTEM DESCRIPTION	ULTRAWOOD Secret Fixed to STUDTEK Top Hat Framing with Weather Barrier
FACADE MATERIAL	ULTRAWOOD Non-Combustible Timber Cladding
COLOUR	Refer External Finishes Schedule
FIXING METHOD	Secret Mechanical Screw Fix – Horizontal Layout
SUB-FRAME SYSTEM	STUDTEK Top Hat Framing
WEATHER BARRIER	ULTRAPERM Class 4 Vapour Permeable Membrane



ULTRAWOOD

Colour Chart

Ultrawood Colours

							
UW0123 Alabama White	UW0903 Ivory Coast	UW1315 Miry Oak	UW0402 Dusty Balsa	UW2015 Tasmanian Oak	UW1816 Rustic Pine	UW0615 Golden Oak	UW0120 African Teak
							
UW0813 Honey Maple	UW1907 Banjo Gum	UW0515 English Oak	UW2311 Woodstock	UW0406 Douglas Fir	UW1903 Southern Cyprus	UW0220 Burmese Teak	UW1005 Japanese Elm
							
UW1540 Dark Cedar	UW1102 Khaya Bean	UW1523 Old Walnut	UW0223 Black Wenge	UW1813 Rich Mahogany	UW1809 Red Iroko	UW1403 Native Cherry	UW2303 West Coast Cedar
							
UW0302 Coastal Blackwood	UW1120 Kontiki Balsa	UW0103 Alaskan Cedar	UW1703 Queensland Cedar	UW1510 Meranti	UW2203 Vancouver Cedar	UW0318 Californian Redwood	UW2503 Yukon Cedar
							
UW1410 Nannup Jarrah	UW0202 Bowral Bluegum	UW1311 Manjimup Karri	UW1580 African Ebony				

Material Colours

							
UL0102 Authentic Brushed	UL0116 Authentic Polished	UL0114 Authentic Natural	UL0318 Coral Rust	UL1914 Scintillation	UL2118 Uluru Rust	UL0418 Dark Rust	UL2116 Uluru Polished
							
UL2114 Uluru Natural	UL0202 Bronze Brushed	UL1502 Ochre Brushed	UL1514 Ochre Natural				

CLYDESTONE SQUARE

Architect Rothelowman Architects

Builder ADCO Constructions

Address Matterhorn Drive, Clyde North VIC 3978

Product ULTRAWOOD 340 x 25mm Castellated Profile

Colour



UW1315
Miry Oak



ULTRAWOOD

MURDOCH HEALTH PRECINCT

- Architect** Hassell Studio (WA)
- Builder** Multiplex
- Address** Kwinana Freeway & Lot 118 South Street, Murdoch WA 6150
- Product** ULTRAWOOD 155 x 18mm Groove Cladding
- Colour**



UW0515
English Oak



BULLA ROAD, STRATHMORE

- Architect** DW Architects & Interiors
- Builder** Chisel Developments
- Address** 80 Bulla Road, Strathmore VIC 3041
- Products** ULTRAWOOD 155 x 18mm Groove Cladding
- Colours**



UW1907
Banjo Gum



ULTRAWOOD

ONE SUBIACO APARTMENTS

- Architect** Hames Sharley
- Builder** Multiplex
- Address** 24 Rokeby Road, Subiaco WA 6008
- Product** ULTRAWOOD 155 x 18mm Groove Cladding
- Colour**



UW1540
Dark Cedar

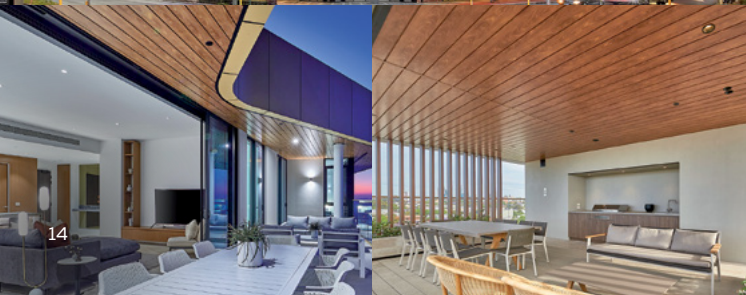

BROOKLANE SHOPPING CENTRE

- Architect** TRCB (Taylor Robinson Chaney Broderick)
- Builder** Capstone Constructions
- Address** 80 Maffina Parade, Ellenbrook WA 6069
- Product** ULTRAWOOD 155 x 18mm Groove Cladding
- Colour**



UW0515
English Oak



ULTRAWOOD

HILLARYS BEACH CLUB

- Architect** SPH Architecture + Interiors
- Builder** Subiaco Building Company
- Address** 20 John Wilkie Tarn, Hillarys WA 6025
- Products** ULTRAWOOD 155 x 18mm Groove Cladding
ULTRAWOOD 100 x 50mm Batten
ULTRAWOOD 150 x 50mm Batten

Colours



UW0302
Coastal Blackwood



SANCTUARY APARTMENTS

Architect MJA Studio

Address 3 Wren Street, Mt Pleasant WA 6153

Products ULTRAWOOD 155 x 18mm Groove Cladding

Colours



UW1540
Dark Cedar



ULTRAWOOD

MASONIC CARE WA

- Architect** Doepel Marsh Architects
- Builder** BADGE Constructions
- Address** 6 Eveline Road, Middle Swan WA 6056
- Products** ULTRAWOOD 155 x 18mm Groove Cladding
ULTRAWOOD 50 x 50mm Batten

Colours



UW0515
English Oak



UW1813
Rich Mahogany



INGLEWOOD SHOPPING CENTRE

Architect Brown Falconer (WA)

Builder Broad Construction

Address 861 Beaufort Street, Inglewood WA 6052

Product ULTRAWOOD 155 x 18mm Groove Cladding

Colour



UW1580
African Ebony





We've Got It Covered



V0525



Blue Chip Group Pty Ltd

SYDNEY | MELBOURNE | BRISBANE | PERTH | ADELAIDE

P 1300 945 123

E sales@bluechipgroup.net.au

www.bluechipgroup.net.au

DISCLAIMER No information or advice contained in this publication is binding in any way shape or form and is provided on a without prejudice basis. All photographs and colour swatches are indicative only. All dimensions are nominal and all product data and specifications are subject to change without notice. All pricing, sales, communications and transactions are subject to Blue Chip Group's terms of trading which are available on request.